



GAMMA 242 SERIES

1-3/8" 6 Spline PTO Thru Shaft

Multiple Drive Options Available
600 RPM



- Anodized Aluminum Crankcase
- High Strength Aluminum Connecting Rods
- Solid Ceramic Plungers
- Stainless Steel Check Valves
- 2" Hose Barb Inlet.
- (4) 3/4" BSP-F Outlet
- 64 oz. Capacity Vented Oil Bath Crank Case
- Max Fluid Temp, 160°F

TS 1C
1-3/8" PTO x
35mm Keyed



TS 2C
1-3/8" PTO x
1-3/8" PTO



GAMMA 242 Series Plunger Pumps

GAMMA 242 Series industrial duty plunger pumps are rated at 63.4 GPM and pressures up to 870 PSI.

Pumps are available with a 1-3/8" male PTO through shaft with the option of a 2nd 1-3/8" male PTO shaft or a 35mm solid, keyed shaft.

Applications include fire fighting,, construction, de-icing and orchard spraying.

	Model	Flow		Pressure		Plunger Dia.	Crankshaft		Power	Seal Kit	Valve Kit	Wt.
		GPM	l/min	PSI	bar		Stroke	Code				
600 RPM	GAMMA 242 TS 1C	63.4	240.0	870	60	50mm	38.0mm	V	36.9 EBHP	6062.71	6062.70	115 lbs
	GAMMA 242 TS 2C	63.4	240.0	870	60	50mm	38.0mm	V	36.9 EBHP	6062.71	6062.70	115 lbs



**World Leader in
Diaphragm and Plunger Pumps**

6180 140th Avenue NW
Ramsey, MN 55303

Ph: 651-785-0666
Fax: 800-732-2670

www.udorusa.com
sales@udorusa.com



Scan this QR Code
for More Information

**G242TS
2026A**

MAX FLOW
MAX PRESSURE
RATED PUMP SPEED
POWER REQUIREMENT
LUBRICATION

63.4 GPM / 240.0 L/MIN
870 PSI / 60 BAR
600 RPM
36.9 HP ELECTRIC
64 OZ UDOR LUBE

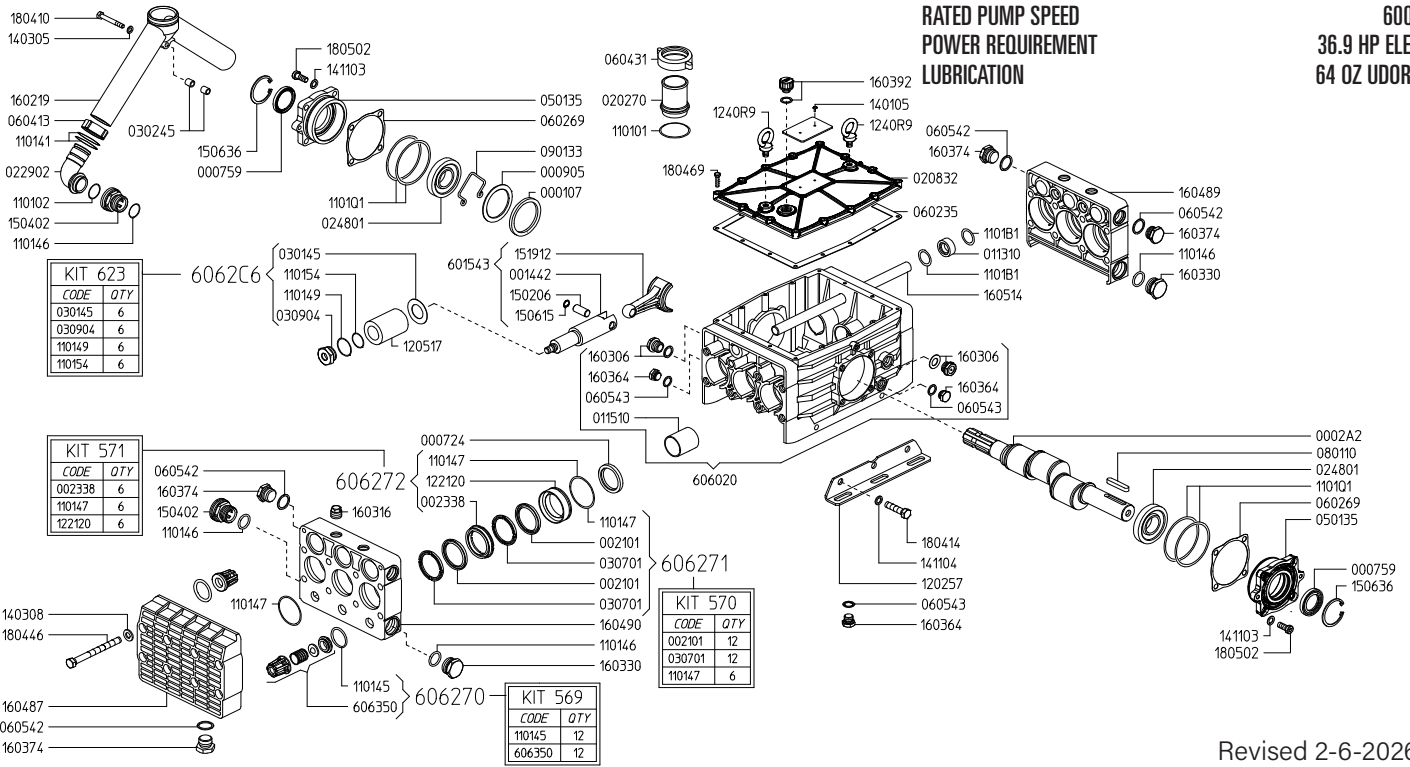

Revised 2-6-2026

Part #	Description	Qty
0001.07	RETAINER RING	6
0002.A2	SHAFT TS1C	1
0007.24	OIL SEAL D40	6
0007.59	OIL SEAL D35	2
0009.05	RING	6
0014.42	PLUNGER GUIDE	6
0021.01	PISTON SEAL RING D50 ^B	12
0023.38	UPPER RING D50 ^C	6
0113.10	BALANCING TUBE BUSHING	2
0115.10	BUSHING D40	6
0202.70	HOSE BARB D50	1
0208.32	UPPER COVER	1
0229.02	BRASS ELBOW	2
0248.01	ROLLER BEARING D35	2
0301.45	DISC ^D	6
0302.45	SPACER	2
0307.01	SPACER RING D50 ^B	12
0309.04	NUT D50 ^D	6
0501.35	BEARING FLANGE	2
0602.35	UPPER COVER GASKET	1
0602.69	FLANGE GASKET	2
0604.13	BRASS NUT M46X2	2
0604.31	BRASS NUT G2"	1
0605.42	GASKET D27	9
0605.43	GASKET D17	3
0801.10	KEY A10X8X55	1
0901.33	SPRING CLIP	1
1101.01	O-RING - INLET BARB	1
1101.02	O-RING - INLET ELBOW	2
1101.41	O-RING - SUCTION MANIFOLD	4
1101.45	O-RING - VALVE ^A	12
1101.46	O-RING - INLET PLUG / INLET ELBOW	6
1101.47	O-RING - SPLIT MANIFOLD	6
1101.47	O-RING - SEAL KIT ^{B,C}	6
1101.49	O-RING - PLUNGER NUT ^D	6
1101.54	O-RING - PLUNGER ^D	6
1101.B1	O-RING - BALANCING TUBE	4
1101.Q1	O-RING - BEARING FLANGE	4
1202.57	BASE PLATE	2

Part #	Description	Qty
1205.17	CERAMIC PLUNGER D50	6
1221.20	PRESSURE RING D50 ^C	6
1401.05	RIVET UNI7346-3.5X8	2
1403.05	WASHER D8.4	1
1403.08	WASHER D13	16
1411.03	SERRATED WASHER D10	8
1411.04	SERRATED WASHER D12	6
1502.06	PIN D15X32.3	6
1504.02	BRASS INLET CONNECTOR	2
1506.15	SNAP RING D15	6
1506.36	SNAP RING D55	2
1519.12	CONNECTING ROD	6
1602.19	SUCTION MANIFOLD G2"	1
1603.06	OIL PLUG G1/2 + GASKET	2
1603.16	PLUG G1/2	4
1603.30	PLUG G1"	2
1603.64	PLUG G3/8	3
1603.74	PLUG G3/4	9
1603.92	OIL PLUG G1/2	1
1604.87	FRONT HEAD	2
1604.89	MIDDLE HEAD - LEFT	1
1604.90	MIDDLE HEAD - RIGHT	1
1605.14	BALANCING TUBE	1
1804.10	HEX BOLT M8X60	1
1804.14	HEX BOLT M10X1.5X65	6
1804.46	HEX BOLT M12X130	16
1804.69	HEX BOLT M6X25	12
1805.02	ALLEN BOLT M10X25	8
6015.43	COMPLETE ROD ASSEMBLY	6
6060.20	CRANKCASE ASSEMBLY	1
6063.50	VALVE ASSEMBLY W/O O-RING ^A	12
6062.70	IN/OUTLET VALVE KIT (KIT 569)	1
6062.71	WATER SEAL KIT (KIT 570)	1
6062.72	BRASS RING KIT (KIT 571)	1
6062.C6	PLUNGER KIT (KIT 623)	1

^A Parts in 6062.70 (Kit 569)

^B Parts in 6062.71 (Kit 570)

^C Parts in 6062.72 (Kit 571)

^D Parts in 6062.C6 (Kit 623)

